

FLOAT

External Shovel Carry Attachment Instructions

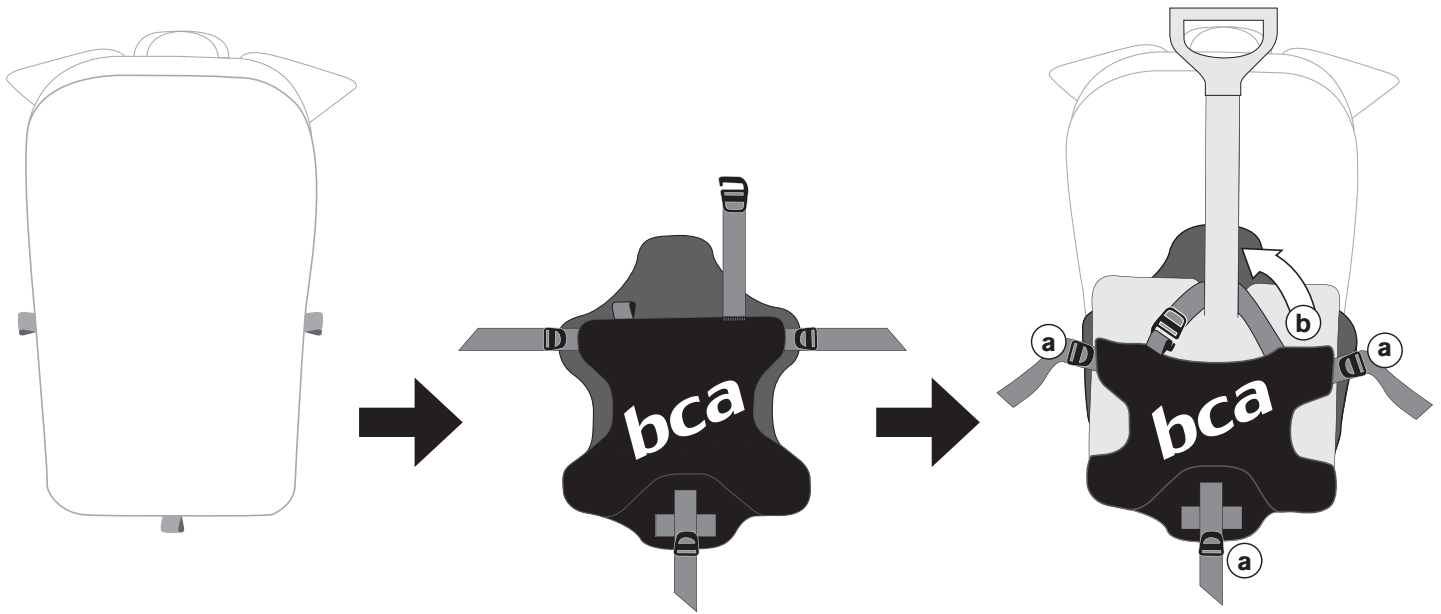

1. Start with pack facing up. Lay the shovel carry accessory on top, also facing up.
2. Insert each of the three strap buckles onto loops on the pack. Loop the webbing back through the buckles and tighten.
3. Slide the shovel blade between the accessory's two pieces of fabric.
4. Take the webbing at the top of the accessory, pass it over the top of the shovel blade and through one of the daisy chain loops. Slide on the open ended hook to secure the shovel.

Accessory can be used to secure shovel with or without shaft attached.

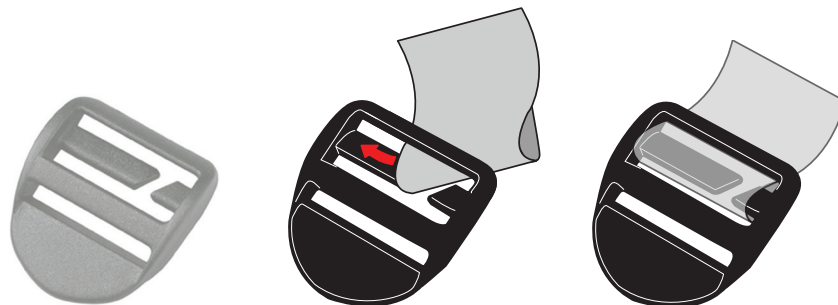

WARNING: Ensure all connections between the pack and shovel attachment are secure before each use. Shovel should be snug and top hook engaged to ensure the shovel does not release from attachment.

FLOAT

External Shovel Carry Attachment Instructions

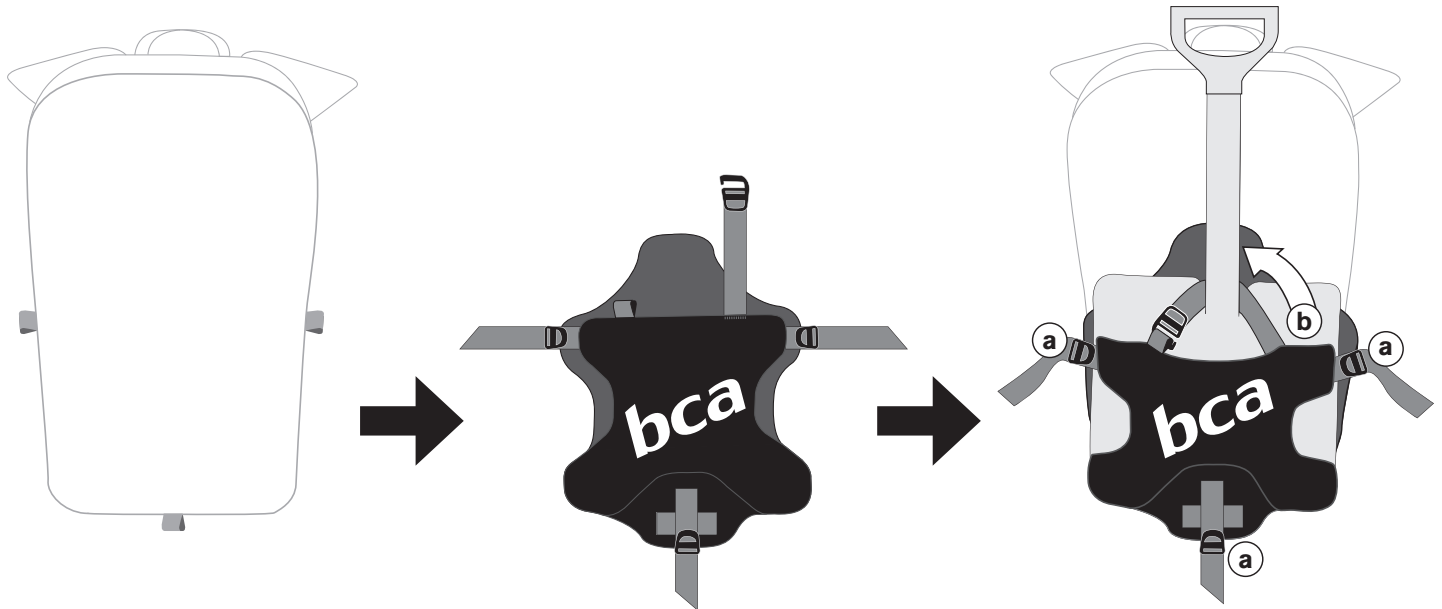

1. Start with pack facing up.
Lay the shovel carry accessory on top, also facing up.
2. Insert each of the three strap buckles onto loops on the pack.
Loop the webbing back through the buckles and tighten.
3. Slide the shovel blade between the accessory's two pieces of fabric.
4. Take the webbing at the top of the accessory, pass it over the top of the shovel blade and through one of the daisy chain loops. Slide on the open ended hook to secure the shovel.

Accessory can be used to secure shovel with or without shaft attached.